



## Fruit Tree Rootstocks

All fruit trees are grafted onto rootstocks that determine the eventual height, growth rate and required spacing of the tree. Some rootstocks are selected for other properties such as disease resistance or cold tolerance. Common eventual heights and approximate planting distances are given below. All of our fruit tree listings have the rootstock in the description.

APPLE ROOTSTOCKS		EVENTUAL HEIGHT	PLANTING DISTANCE
<b>M27</b>	Dwarf rootstock, excellent for small gardens and step-overs	1.2-1.8m	1.8-2.5m
<b>M9</b>	Dwarf rootstock, excellent for small gardens	1.8-2.4m	1.8-3m
<b>M26</b>	Semi-dwarf rootstock, will need staking Good for bush in limited spaces	2.4-3m	2.5-3.5m
<b>MM106</b>	Semi-dwarfing and the most popular rootstock Generally used for half standard trees	3-4m	3-4.5m
<b>MM111</b>	Vigorous. Usually used for standards and half standards	4-5m	4.5m
<b>M25</b>	Very vigorous, excellent for standards	4.5-6m	
<b>M9</b>	Dwarf tree. Bush rootstock often used for cordons	2.5m	2.5m

PEAR ROOTSTOCKS		EVENTUAL HEIGHT	PLANTING DISTANCE
<b>Quince C</b>	Dwarf rootstock, will need staking and earlier to crop	2.5m	1.8-2.5m
<b>Quince A</b>	Semi-vigorous rootstock that will need staking Good for bush in limited spaces	3m	2.5-3m
<b>Quince Eline</b>	Dwarf rootstock, will need staking. Cold hardy	2.5m	1.8-2.5m

CHERRY ROOTSTOCKS		EVENTUAL HEIGHT	PLANTING DISTANCE
<b>Gisela 5</b>	Semi dwarfing	3m	
<b>Colt</b>	Semi-vigorous	4-5m	

PLUM, GAGE & APRICOT ROOTSTOCKS		EVENTUAL HEIGHT	PLANTING DISTANCE
<b>Pixy</b>	Dwarf rootstock, will need staking	2.5m	1.8-2.5m
<b>St Julien A</b>	Semi-vigorous. Generally used for half standard trees	4m	3-4.5m

PATIO ROOTSTOCKS			
Many fruiting trees are available on patio rootstocks. They are a perfect option for growing in a container with plants reaching 1.2m - 1.8m height			

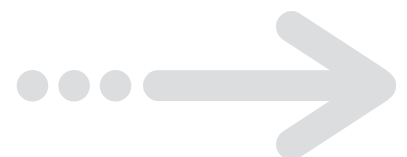



# Fruit Tree Rootstocks

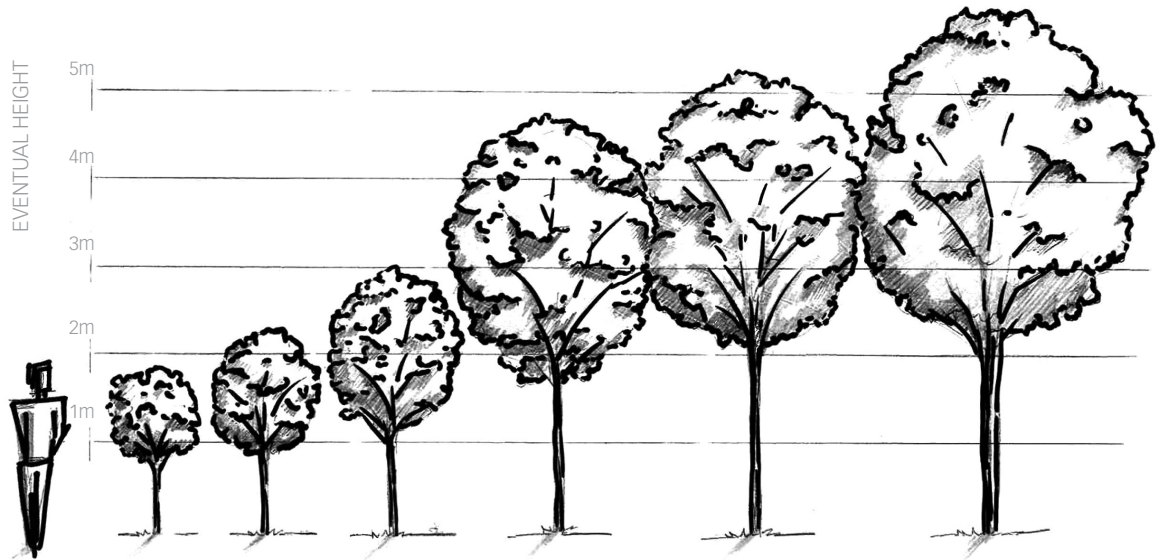

ROOTSTOCK						
<b>Apple</b>	M27	M9	M26	MM106	MM111	M25
<b>Pear</b>	Quince C/Quince Eline			Quince A		
<b>Cherry</b>	Gisela			Colt		
<b>Plum, Gage and Apricot</b>	Pixy			St Julien A		

01322 662315

[www.provendernurseries.co.uk](http://www.provendernurseries.co.uk)



## Fruit Tree Pollination

All fruit trees require a pollinator to ensure an abundant crop. Bees and other insects will do this work for you pollinating your fruit trees but in order to get maximum yield, planting a pollinator nearby will increase productivity. Pollinators should be planted in close proximity to your fruit tree to allow cross-pollination.

### Pollination Groups

Pollination groups are split into five flowering groups; 1, 2, 3, 4 and 5. Pollinators must be of the same type, e.g both apples or both pears.

Pollination groups are determined by the approximate flowering time which is normally a month long so overlap between pollination groups can occur. Pollinators should be of the same or the next pollination group. See table below.

Pollination groups apply to apples and pears only

POLLINATION GROUP	POLLINATED BY
1	1 & 2
2	1, 2 & 3
3	2, 3 & 4
4	3, 4 & 5
5	5



### Self-Fertile Trees

Self-fertile trees do not need another tree to cross-pollinate although some recommend planting with another of the same type to ensure a good crop.

Self-fertile trees can apply to apple, pear, cherry, damson, plum, gage, quince and apricot.

### Triploid Trees

Triploids do not self-pollinate. They are also poor pollinators and need two pollinators or one self-fertile variety that flowers at the same time to achieve pollination.

There are few Triploid fruit trees available now. Triploids are mainly apple with a few pear varieties.



01322 662315

[www.provendernurseries.co.uk](http://www.provendernurseries.co.uk)

ALL OF OUR FRUIT TREE LISTINGS HAVE THE POLLINATION GROUPS IN THE DESCRIPTION



## Fruit Tree Forms

Fruit trees come in many different forms and with the explosion in 'Grow Your Own' there is much desire for trees that will grow against walls or fences as well as more traditional forms.

### TREE FORM OPTIONS

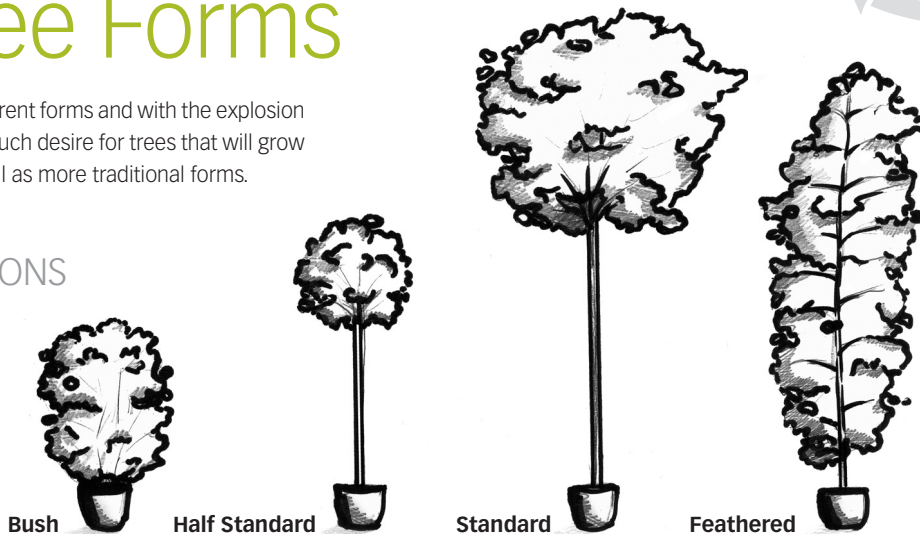

Bush

Half Standard

Standard

Feathered

### WALL/FENCE



**Cordon** - usually U Cordon & Double U - apples and pears only

**Espallier** - normally 2-5 tiers  
apples and pears only

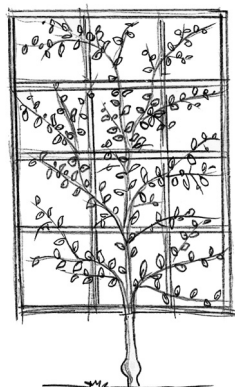

**Frame**

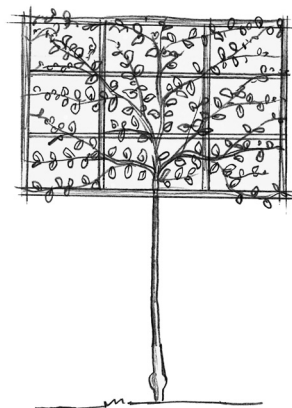

**Pleached** - limited options available



**Fan**

### ORNAMENTAL OPTIONS WHERE SPACE IS LIMITED



**Step-over** - apples and pears only